

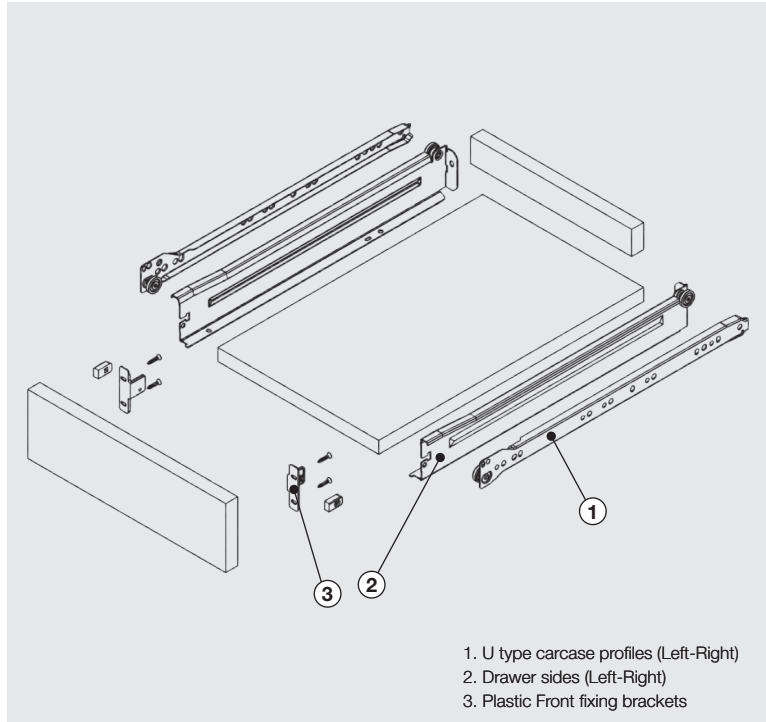



### Specifications

- Aesthetic Steel structure
- Automatic closing from 70 mm
- 400/450/500/550 mm size options
- Electrostatic painting (white)
- Special silent wheel system
- Long service life
- 25 kg. loading capacity
- Safety system to prevent drawer falling
- It is possible to adjust drawer surface vertical-horizontal



### 1-2-3 Drawer Set incl. Screw On Front Connectors

Slide Length	Packing Type	Colour	Code
400 mm.	1 Set	White	6500540
450 mm.	1 Set	White	6500541
500 mm.	1 Set	White	6500542
550 mm.	1 Set	White	6500543

### 1-2 Drawer Set

Slide Length	Packing Type	Colour	Code
400 mm.	1 Set	White	1121041
450 mm.	1 Set	White	1121051
500 mm.	1 Set	White	1121061
550 mm.	1 Set	White	1121071

### 3 Front Connector

Material	Packing Type	Type	Colour	Code
Zamac	Pair	Screw On	Nickel	1121801
Zamac	Pair	Dowel	Nickel	1121803

Indicate if you want to substitute screw on with doweled.

### Soft Close Mechanism

Packing Type	Colour	Code
1 Set	Grey	6500672

Refer to page C9 for technical information

### Required space in the cabinet

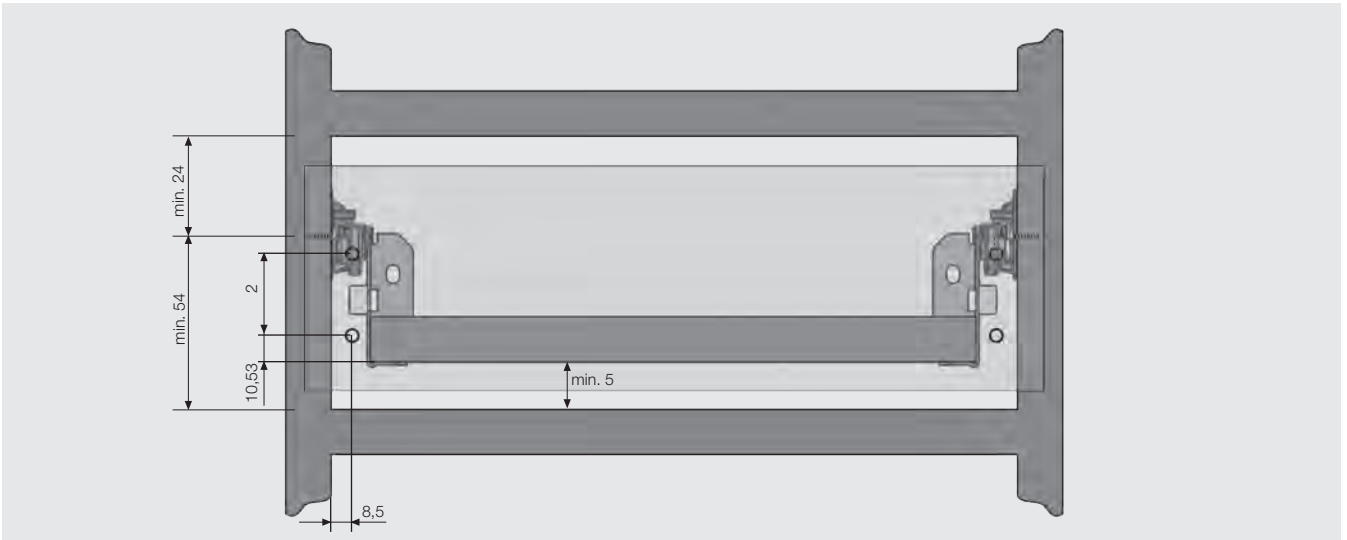

### Dimensioning Formulas

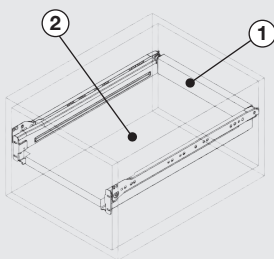

- ①  
 Drawer Back Panel width: Cabinet Inner width 31mm(max.33mm)  
 Drawer Back Panel Height: min.39 mm (for 16 mm chipboard)  
 Drawer Back Panel Height: min 47 mm. (for 8mm chipboard)
- ②  
 Drawer wooden floor width=Cabinet Internal width  
 - 31mm(max.33mm)  
 Drawer wooden floor length=Slide length -1 mm

### Screw Location Dimensions for slides

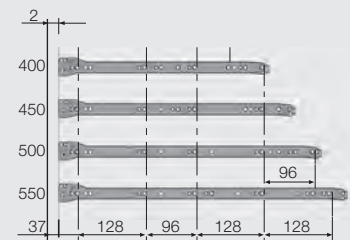

### Wooden Back Panel Application

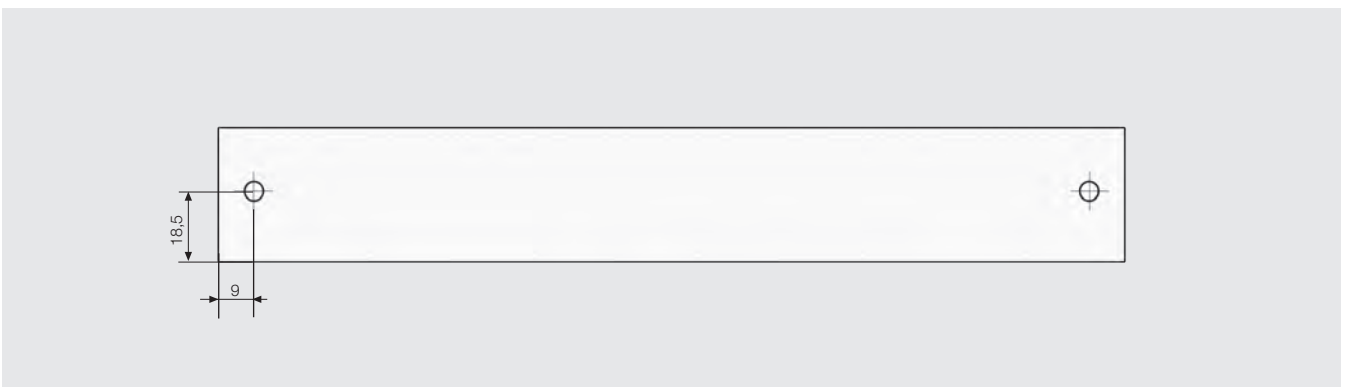

\* All dimensions in the diagram are in mm.



### Specifications

- Aesthetic Steel structure
- Automatic closing from 70 mm
- 250/300/350/400/450/500/550 mm size options
- Electrostatic painting (white)
- Special silent wheel system
- Long service life
- 25 kg. loading capacity
- Safety system to prevent drawer falling
- It is possible to adjust drawer surface vertical-horizontal

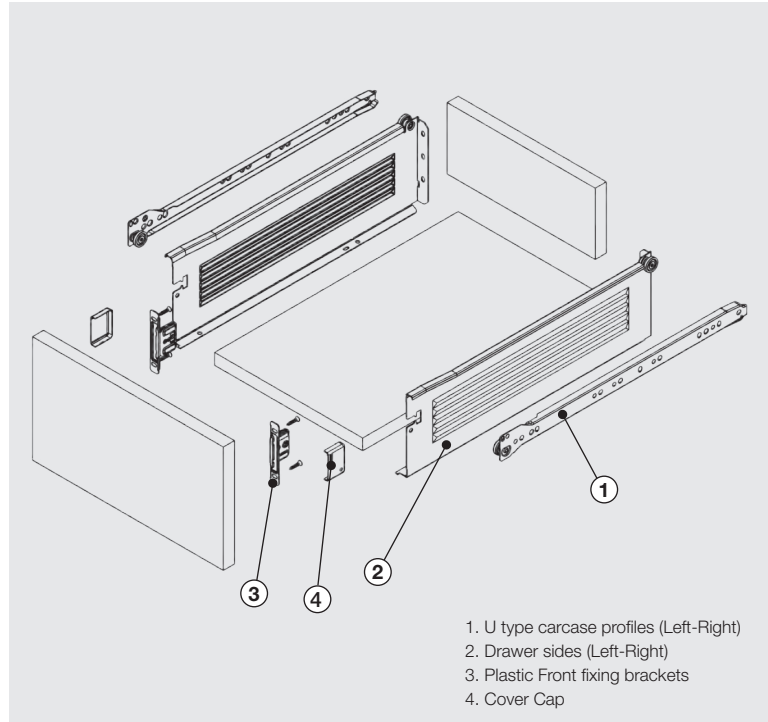

### 1-2-3 Drawer Set incl. Screw On Front Connectors

Slide Length	Packing Type	Colour	Code
250 mm.	1 Set	White	6500590
300 mm.	1 Set	White	6500591
350 mm.	1 Set	White	6500592
400 mm.	1 Set	White	6500593
450 mm.	1 Set	White	6500594
500 mm.	1 Set	White	6500595
550 mm.	1 Set	White	6500596

### 1-2 Drawer Set

Slide Length	Packing Type	Colour	Code
250 mm.	1 Set	White	1121111
300 mm.	1 Set	White	1121121
350 mm.	1 Set	White	1121131
400 mm.	1 Set	White	1121141
450 mm.	1 Set	White	1121151
500 mm.	1 Set	White	1121161
550 mm.	1 Set	White	1121171

### 3 Front Connector

Material	Packing Type	Type	Colour	Code
Zamac	Pair	Screw On	Nickel	6500670
Zamac	Pair	Dowel	Nickel	6500671

Indicate if you want to substitute screw on with doweled.

### 4 Cover Cap

Material	Packing Type	Colour	Code
Plastic	Pair	White	1121821

### Soft Close Mechanism

Packing Type	Colour	Code
1 Set	Grey	6500672

Refer to page C9 for technical information

### Required space in the cabinet

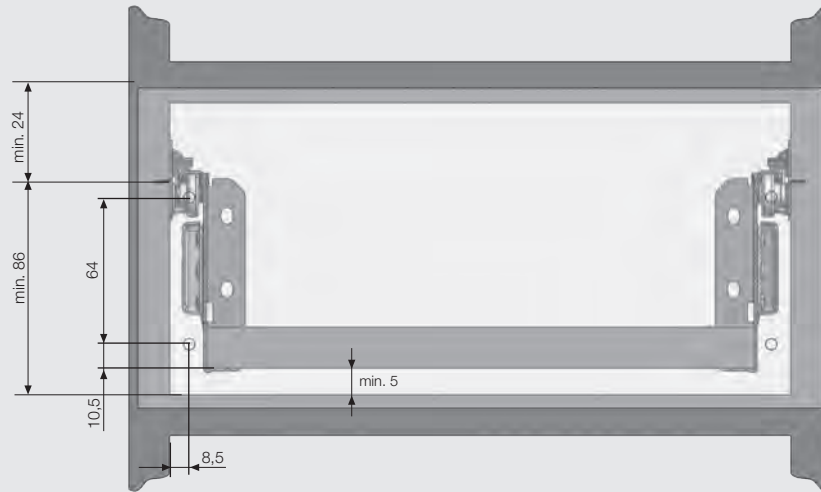

### Dimensioning Formulas

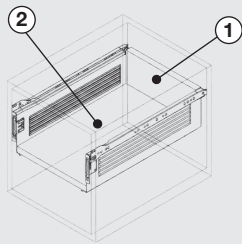

- ① Drawer Back Panel width: Cabinet Inner width -31mm(max.33mm)  
 Drawer Back Panel Height: min.71 mm (for 16 mm chipboard)  
 Drawer Back Panel Height: min 79 mm. (for 8mm chipboard)

- ② Drawer wooden floor width=Cabinet Internal width -31mm(max.33mm)  
 Drawer wooden floor length=Slide length -1mm

### Screw Location Dimensions for slides

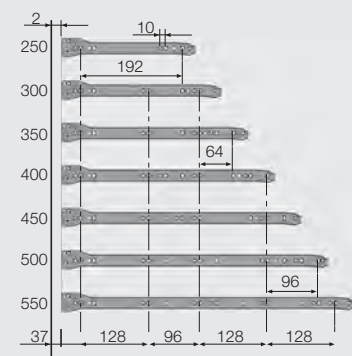

### Back Panel Application

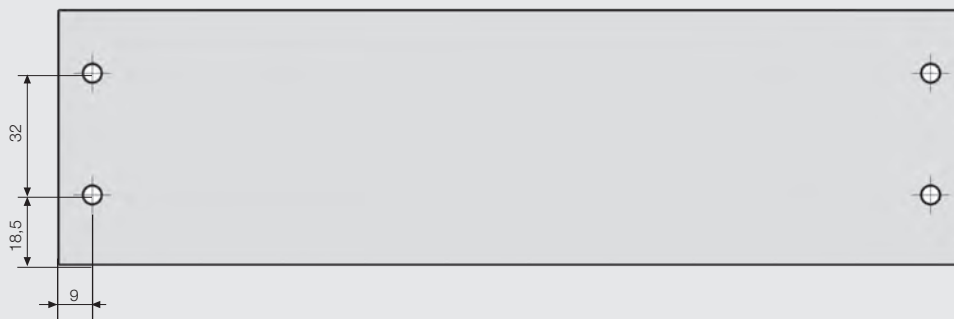

\* All dimensions in the diagram are in mm.



### Specifications

- Aesthetic Steel structure
- Automatic closing from 70 mm
- 300/350/400/450/500/550 mm size options
- Electrostatic painting (white)
- Special silent wheel system
- Long service life
- 25 kg. loading capacity
- Safety system to prevent drawer falling
- It is possible to adjust drawer surface vertical-horizontal

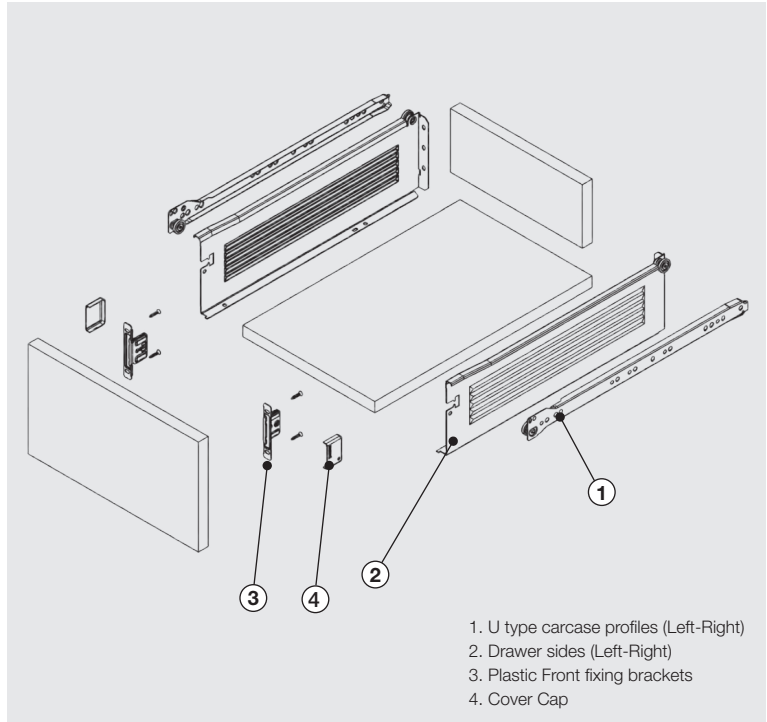

1. U type carcass profiles (Left-Right)
2. Drawer sides (Left-Right)
3. Plastic Front fixing brackets
4. Cover Cap

### 1-2-3 Drawer Set incl. Screw On Front Connectors

Slide Length	Packing Type	Colour	Code
300 mm.	1 Set	White	6500610
350 mm.	1 Set	White	6500611
400 mm.	1 Set	White	6500612
450 mm.	1 Set	White	6500613
500 mm.	1 Set	White	6500614
550 mm.	1 Set	White	6500615

### 1-2 Drawer Set

Slide Length	Packing Type	Colour	Code
300 mm.	1 Set	White	1121221
350 mm.	1 Set	White	1121231
400 mm.	1 Set	White	1121241
450 mm.	1 Set	White	1121251
500 mm.	1 Set	White	1121261
550 mm.	1 Set	White	1121271

### 3 Front Connector

Material	Packing Type	Type	Colour	Code
Zamac	Pair	Screw On	Nickel	6500670
Zamac	Pair	Dowel	Nickel	6500671

Indicate if you want to substitute screw on with doweled.

### 4 Cover Cap

Material	Packing Type	Colour	Code
Plastic	Pair	White	1121821

### Soft Close Mechanism

Packing Type	Colour	Code
1 Set	Grey	6500672

Refer to page C9 for technical information

### Required space in the cabinet

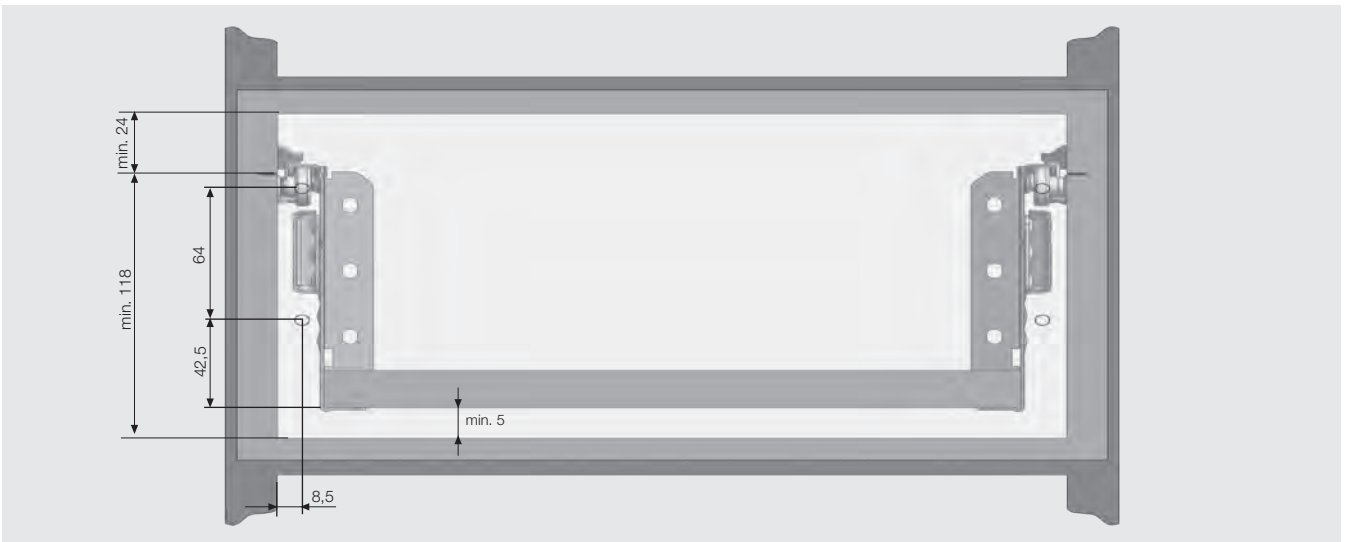

### Dimensioning Formulas

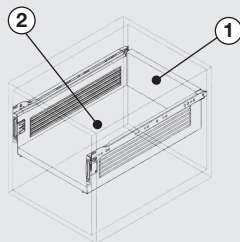

①

Drawer Back Panel width: Cabinet Inner width -31mm(max.33mm)  
 Drawer Back Panel Height: min.103 mm (for 16 mm chipboard)  
 Drawer Back Panel Height: min 111 mm. (for 8mm chipboard)

②

Drawer wooden floor width=Cabinet Internal width -31mm(max.33mm)  
 Drawer wooden floor length=Slide length -1mm

### Screw Location Dimensions for slides

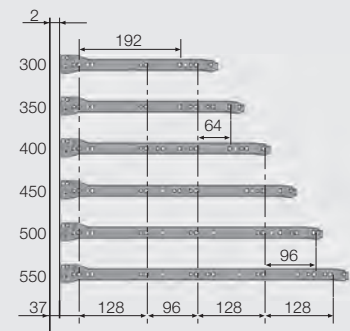

### Wooden Back Panel Application

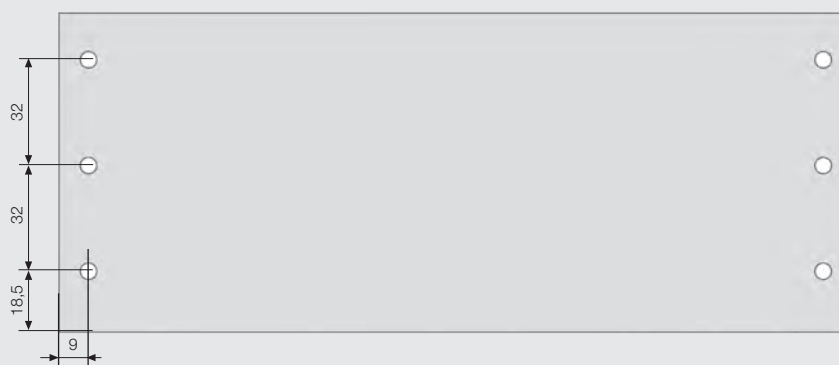

\* All dimensions in the diagram are in mm.



### Specifications

- Aesthetic Steel structure
- Automatic closing from 70 mm
- 300/350/400/450/500/550 mm size options
- Electrostatic painting (white)
- Special silent wheel system
- Long service life
- 25 kg. loading capacity
- Safety system to prevent drawer falling
- It is possible to adjust drawer surface vertical-horizontal

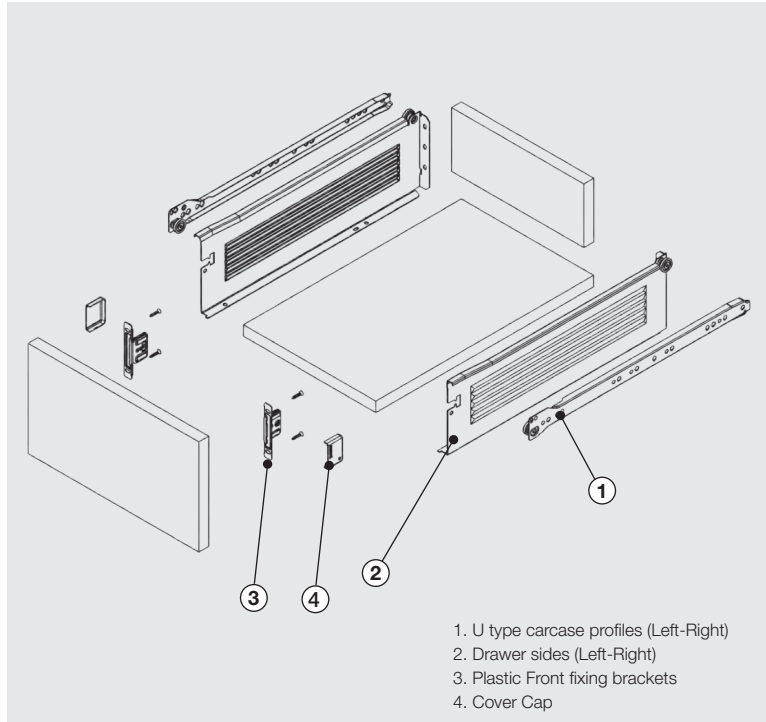

1. U type carcass profiles (Left-Right)
2. Drawer sides (Left-Right)
3. Plastic Front fixing brackets
4. Cover Cap

### 1-2-3 Drawer Set incl. Front Connectors

Slide Length	Packing Type	Colour	Code
300 mm.	1 Set	White	6500640
350 mm.	1 Set	White	6500641
400 mm.	1 Set	White	6500642
450 mm.	1 Set	White	6500643
500 mm.	1 Set	White	6500644
550 mm.	1 Set	White	6500645

### 1-2 Drawer Set

Slide Length	Packing Type	Colour	Code
300 mm.	1 Set	White	1121321
350 mm.	1 Set	White	1121331
400 mm.	1 Set	White	1121341
450 mm.	1 Set	White	1121351
500 mm.	1 Set	White	1121361
550 mm.	1 Set	White	1121371

### 3 Front Connector

Material	Packing Type	Type	Colour	Code
Zamac	Pair	Screw On	Nickel	6500670
Zamac	Pair	Dowel	Nickel	6500671

Indicate if you want to substitute screw on with doweled.

### 4 Cover Cap

Material	Packing Type	Colour	Code
Plastic	Pair	White	1121821

### Soft Close Mechanism

Packing Type	Colour	Code
1 Set	Grey	6500672

Refer to page C9 for technical information



### Required space in the cabinet



### Dimensioning Formulas

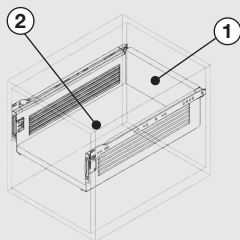

①

Drawer Back Panel width: Cabinet Inner width -31mm(max.33mm)  
 Drawer Back Panel Height:min.103 mm (for 16 mm chipboard)  
 Drawer Back Panel Height: min 111 mm. (for 8mm chipboard)

②

Drawer wooden floor width=Cabinet Internal width -31mm(max.33mm)  
 Drawer wooden floor length=Slide length -1mm

### Screw Location Dimensions for slides

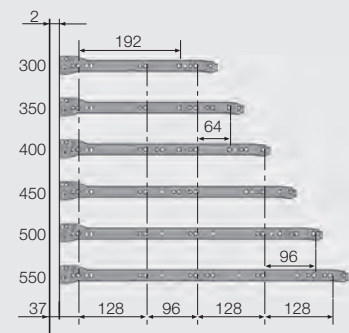

### Back Panel Application

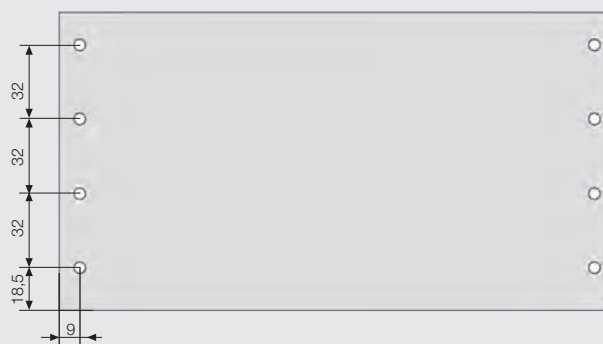

\* All dimensions in the diagram are in mm.

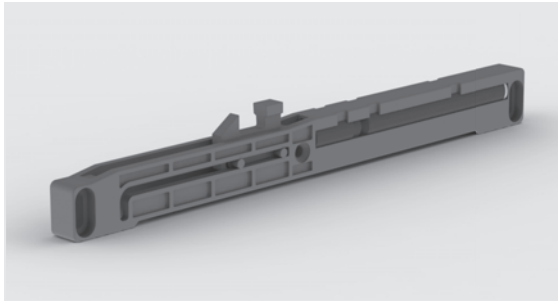

- It is used to add soft closing function to Sam Box drawers
- Same product can be used at right and left sides
- It is advised to use two products for each drawer

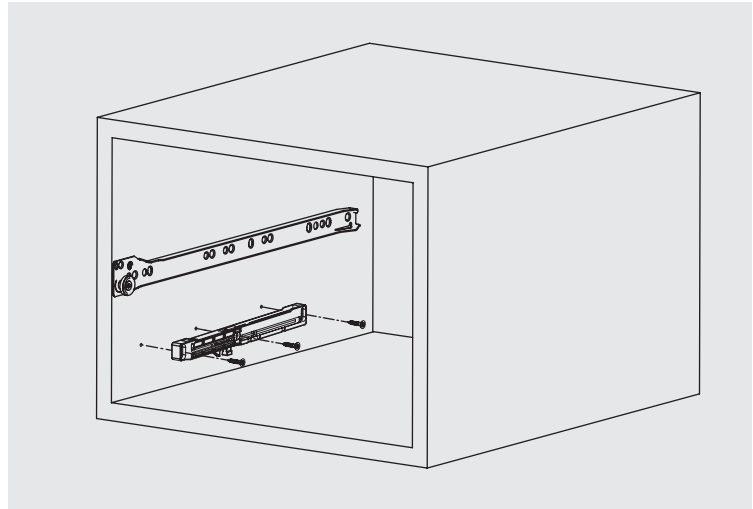

### Soft Close Mechanism

Packing Type	Colour	Code
1 Set	Grey	6500672

### Drive Part Assembly

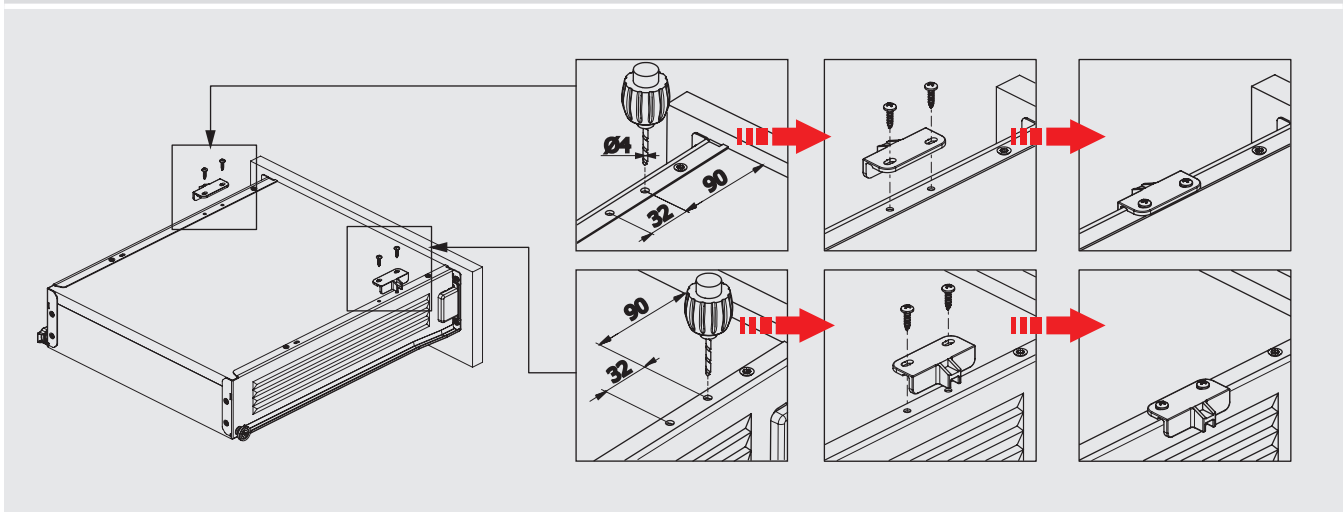

### Soft Close Mechanism Assembly

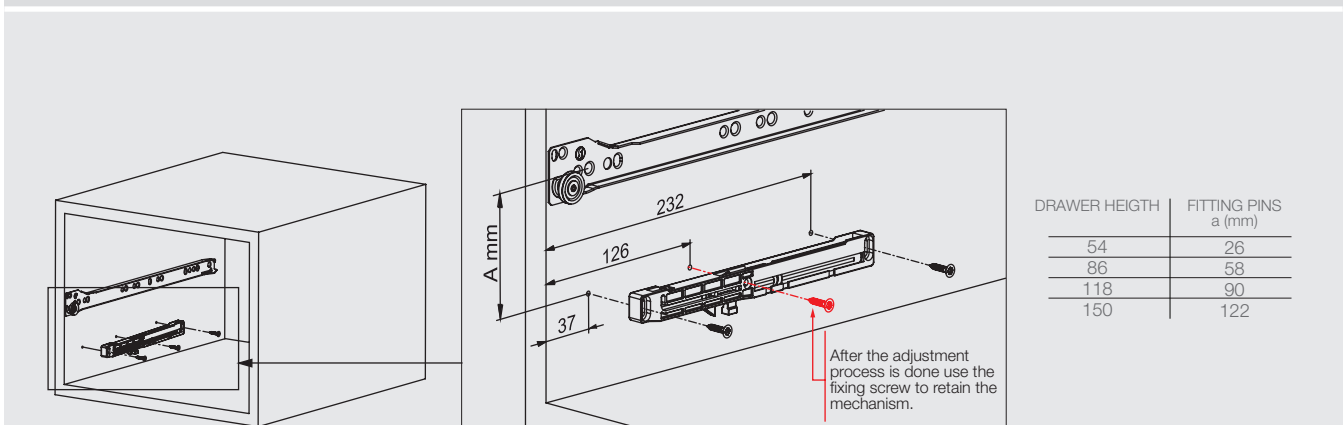

\* All dimensions in the diagram are in mm.

